

ANTO L1016

Parklampe med spot / Post light with spotlights /
Mastleuchte mit spot / Lyktstolpe med spottar

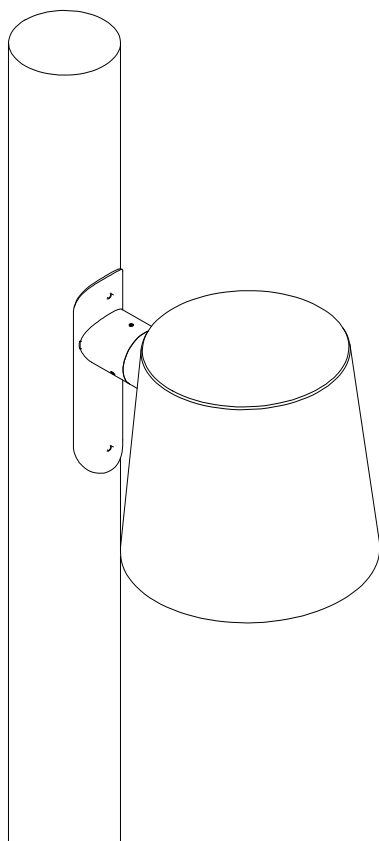

Monteringsvejledning / Mounting instructions /
Installationsanleitung / Installationsinstruktioner

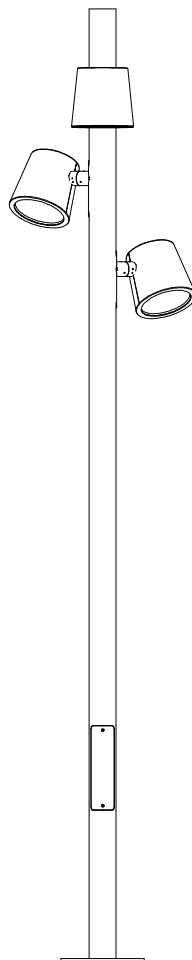

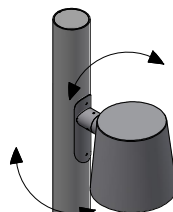
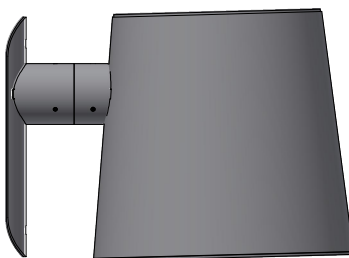
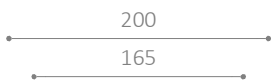

Værktøj / Tool / Werkzeug / Verktøj:



3 mm



4 mm

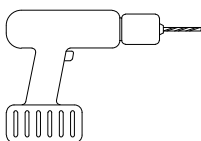

TX20

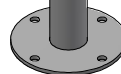

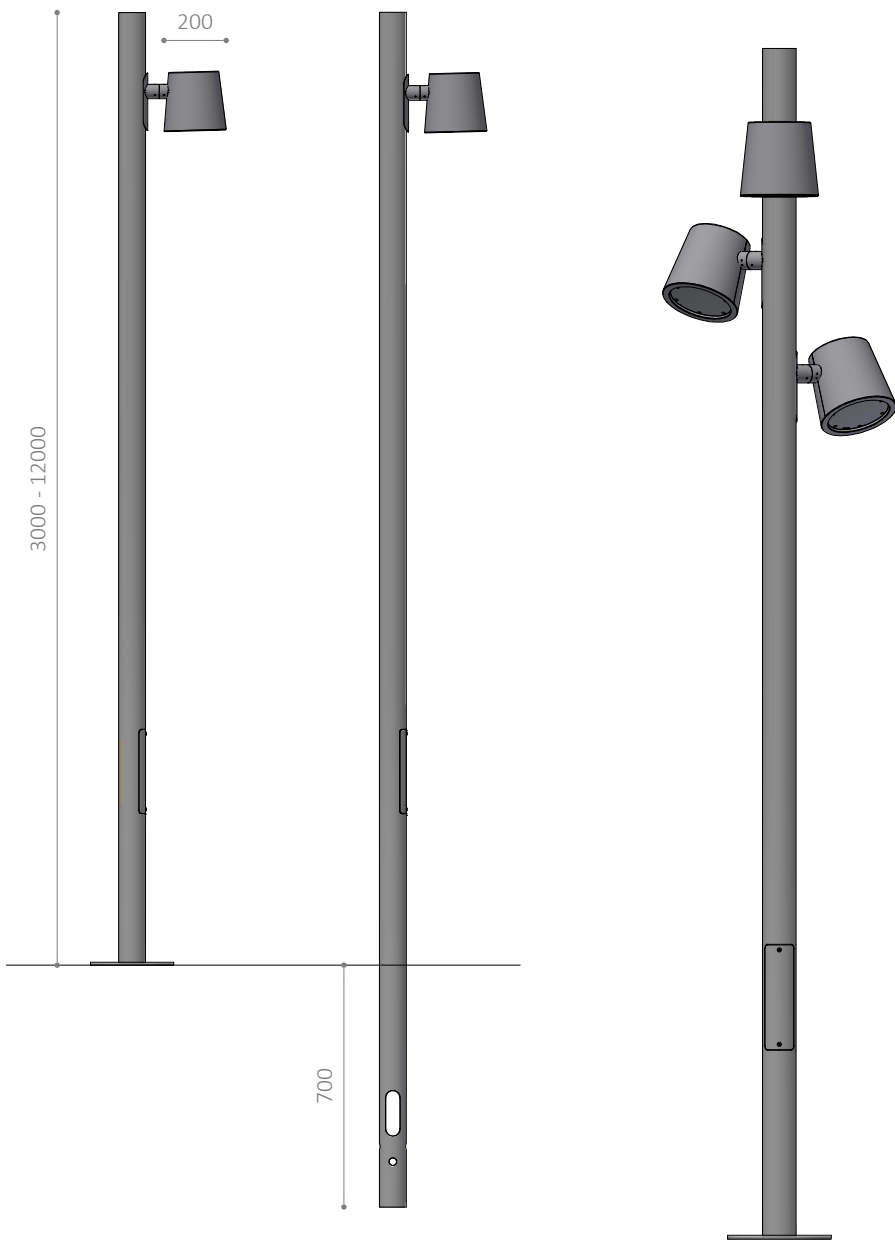

1



4 mm

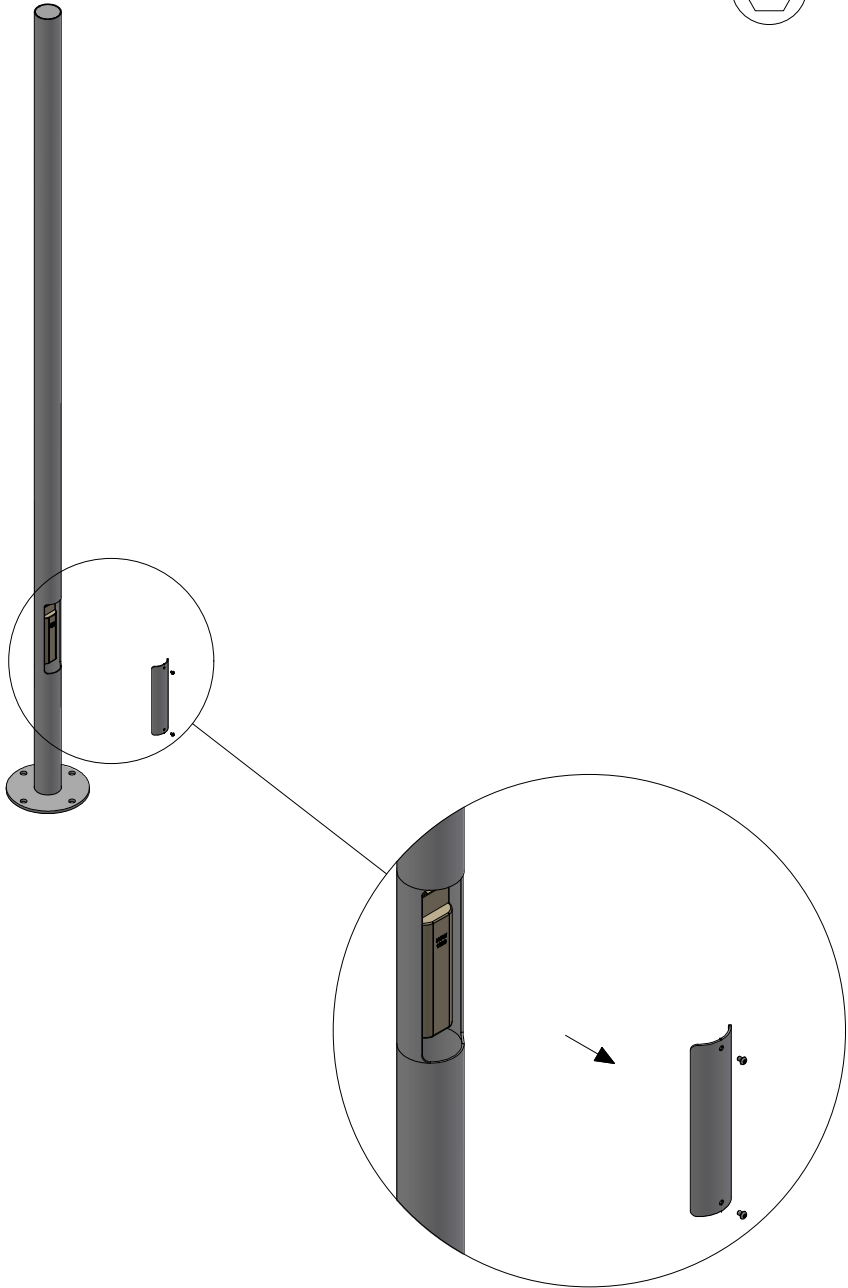

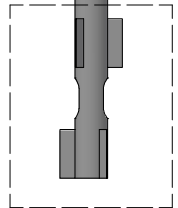
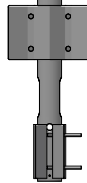
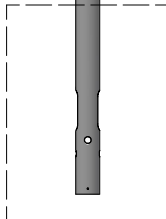
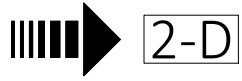
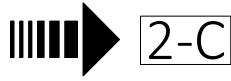
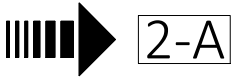

2-A

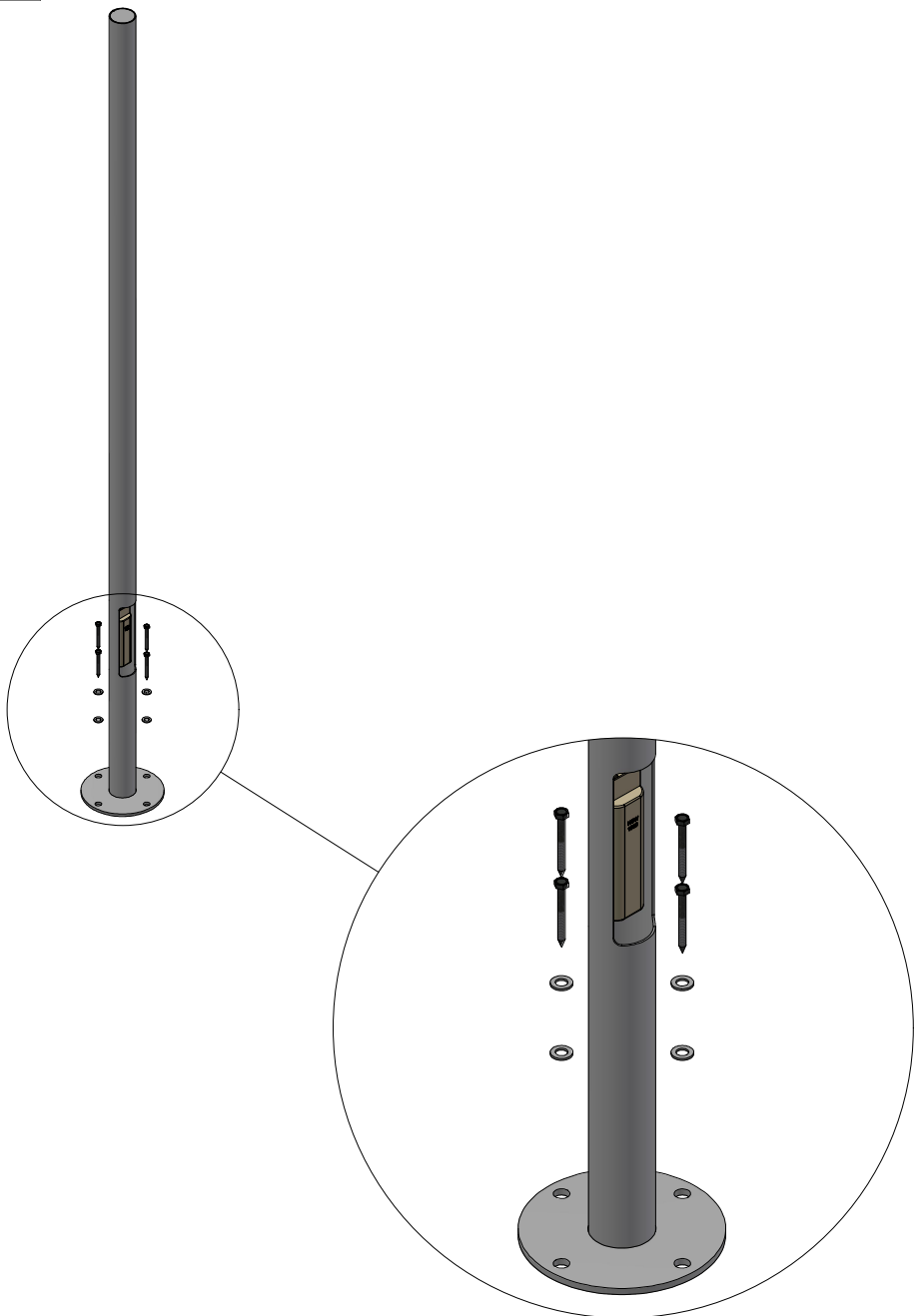

2-B

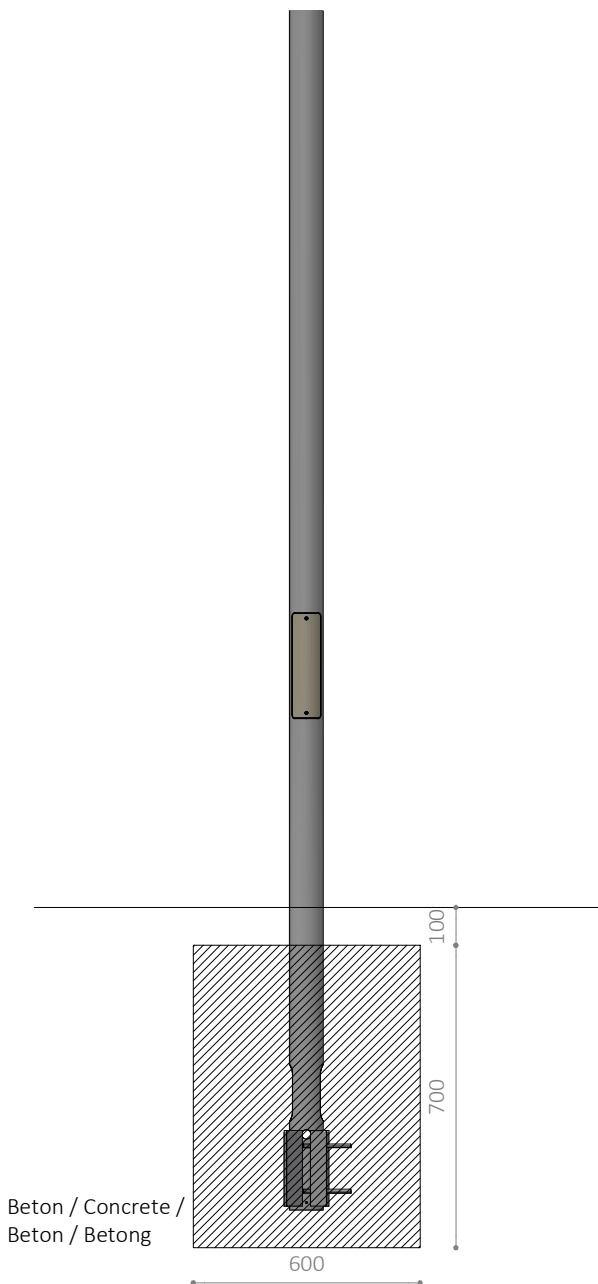

Se monteringsvejledning / See mounting instructions / Siehe
Installationsanleitung / Se Installationsinstruktioner nr. 19651000-96

2-C

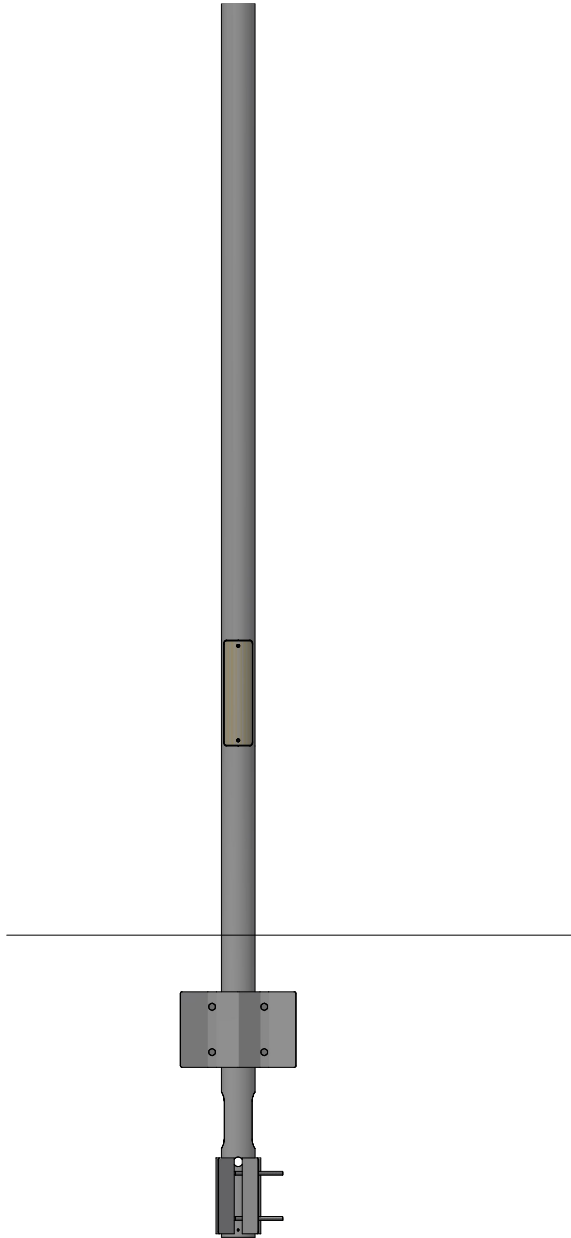

Se monteringsvejledning / See mounting instructions / Siehe
Installationsanleitung / Se Installationsinstruktioner nr. 19651000-96

Lampas A/S, Platinvej 43, 6000 Kolding, T +45 6916 0300, info@lampas.dk, www.lampas.dk

Mont. vejl. nr. 19651100-97 A

2-D

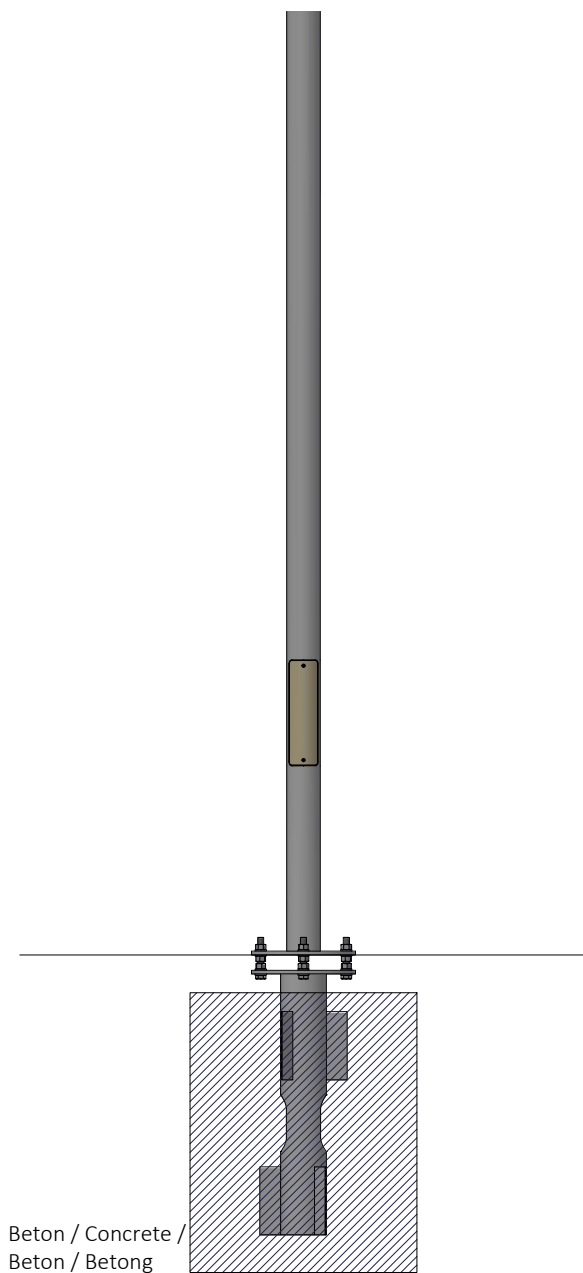

Beton / Concrete /
Betón / Betong

Se monteringsvejledning / See mounting instructions / Siehe
Installationsanleitung / Se Installationsinstruktioner nr. 19651000-95

3

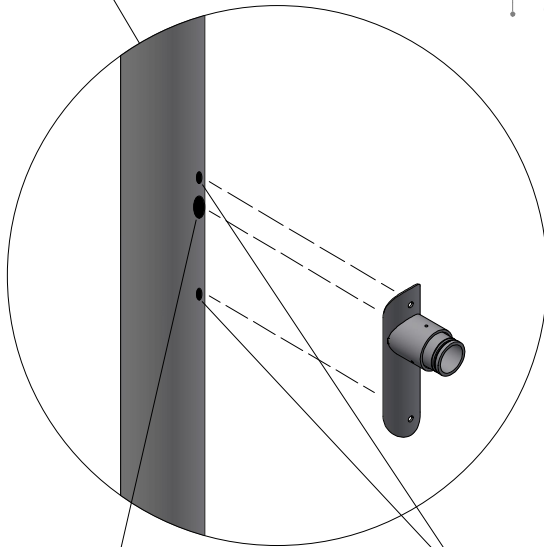
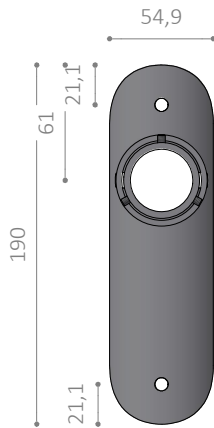
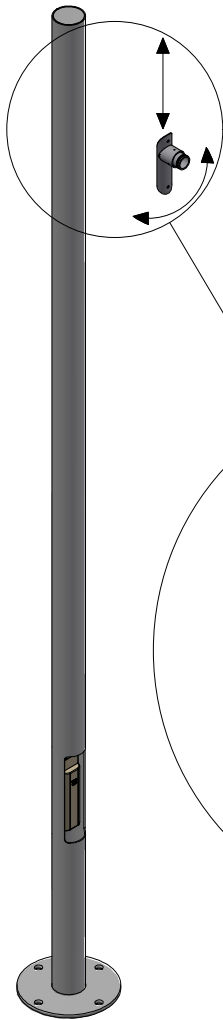

| | |
|---|--|
| 1 | |
| 2 | |
| 3 | |

| | |
|---|--|
| 1 | |
| 2 | |
| 3 | |

4



TX20

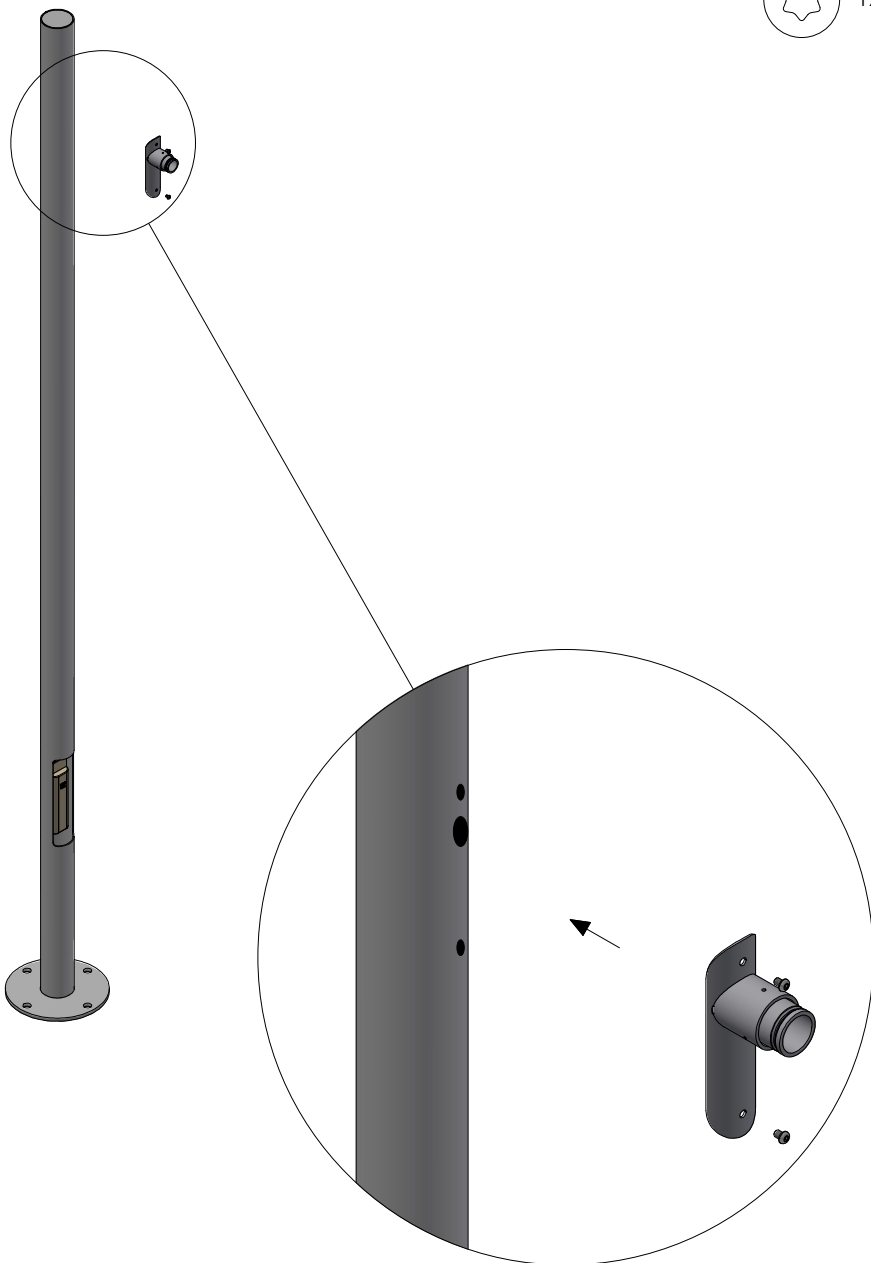

5

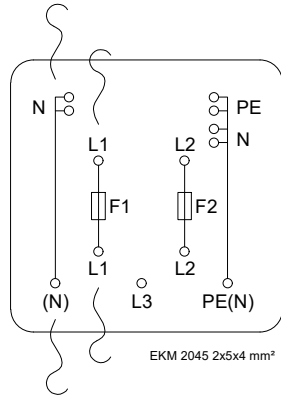
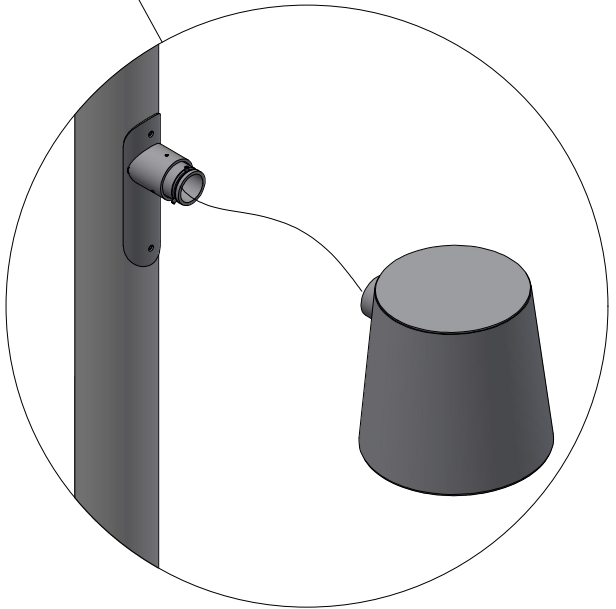
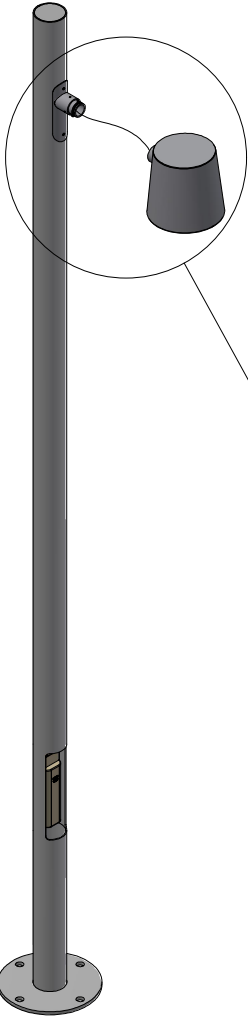

6

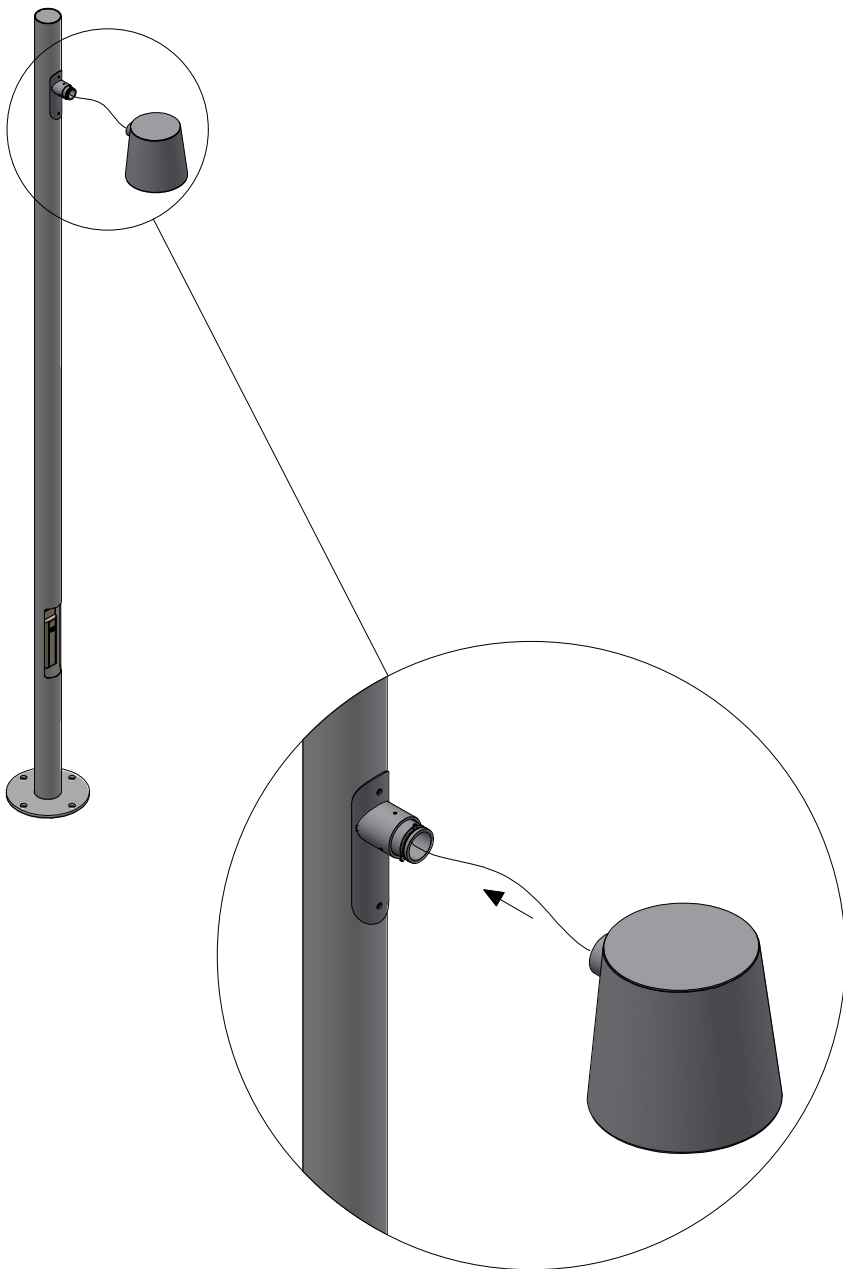

7



3 mm

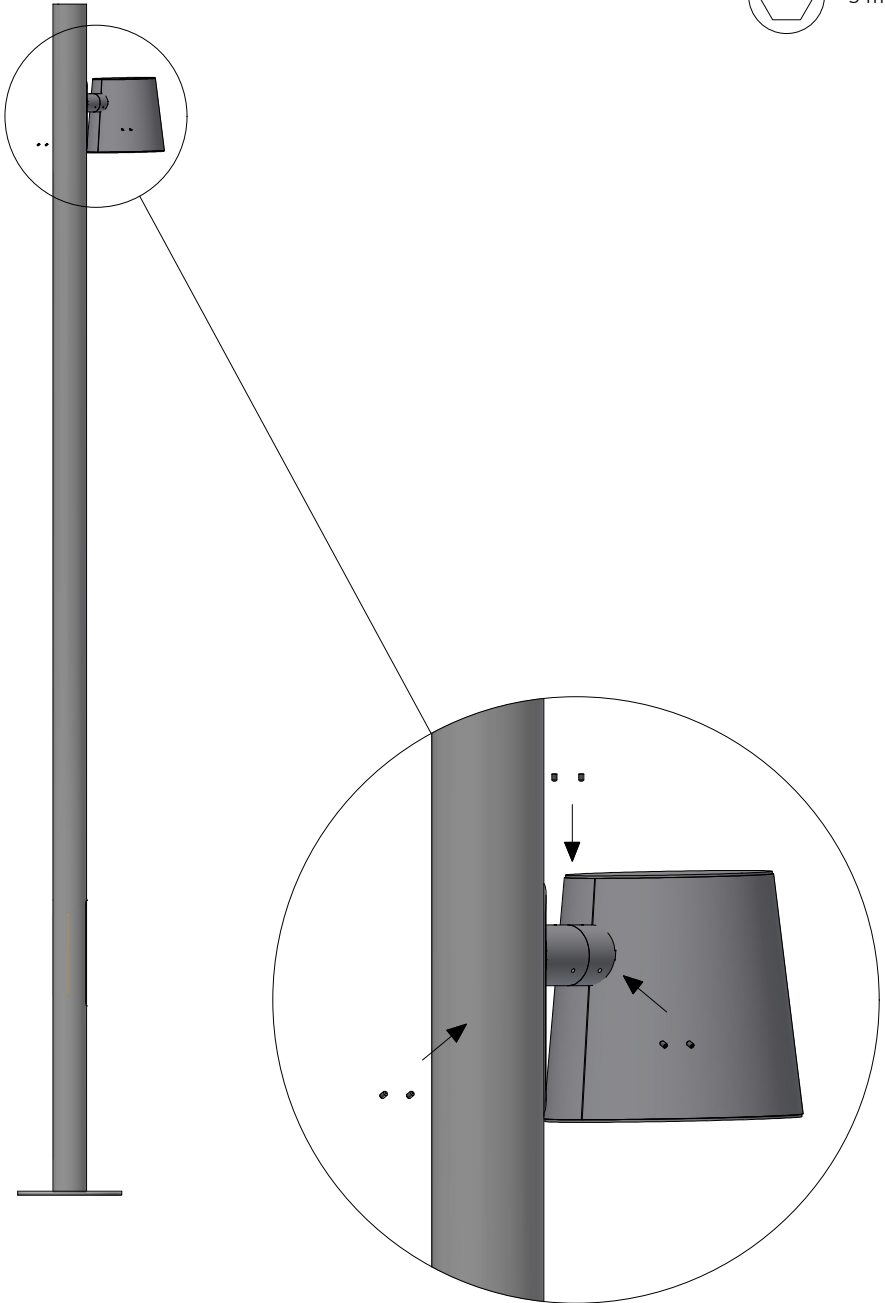

8



4 mm

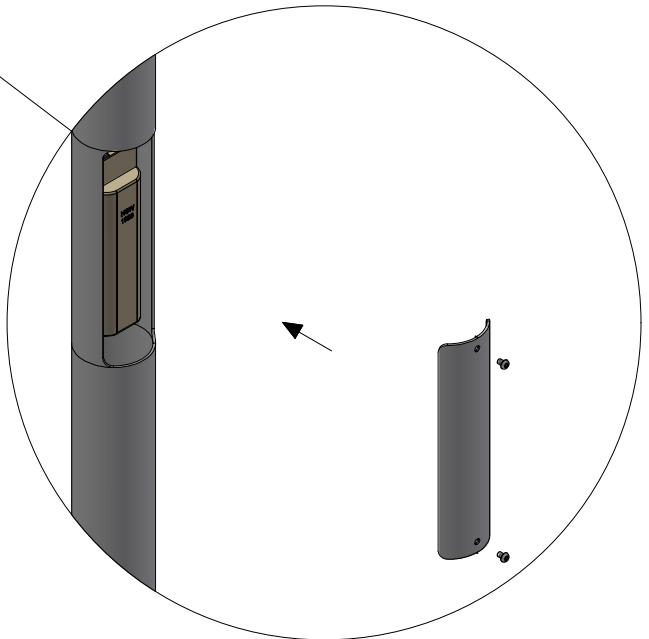
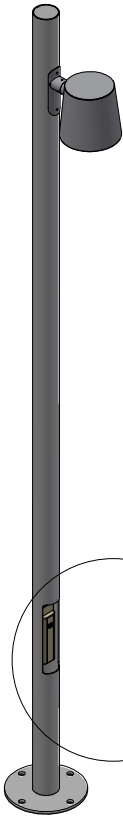



LED



220-240 V 50-60 Hz



Isolationsklasse II / Insulation class II / Schutzklasse II / Isolationsklass II



IP56

IK

IK10



5 kg



Se vedligeholdelses vejledning / See maintenance instructions /
Siehe Wartungsanweisungen / Se underhållsinstruktioner

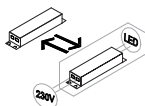

Montering samt udskiftning af lyskilde eller driver må kun udføres af
producenten eller aut. el-installatør /
Installation and replacement of the light source or driver may only be
carried out by the manufacturer or by an authorised electrician /
Die Installation und Austausch der Lichtquelle oder des Treibers darf nur
vom Hersteller oder einem autorisierten Elektriker durchgeführt werden /
Installation och utbyte av ljuskälla eller drivdon får endast utföras av
tillverkaren eller en auktoriserad elektriker.



Dette produkt indeholder en lyskilde i energieffektivitetsklasse: /
This product contains a light source of energy efficiency class: /
Dieses Produkt enthält eine Lichtquelle der Energieeffizienzklasse: /
Denna produkt innehåller en ljuskälla med energieffektivitetsklass:

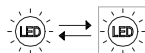

| Luminaire | CCT | Energy Efficiency Class |
|------------------|------------------|-------------------------|
| VERO SE18B gen.7 | CCT 3000, CRI 80 | E |
| VERO SE18B gen.7 | CCT 4000, CRI 80 | E |
| VERO SE18B gen.8 | CCT 2700, CRI 80 | E |

Lampas